

GIMBAL MANIPULATOR

This Phased Array manipulator is designed for manual and semi-automated immersion systems. It can be used to ensure perpendicularity during calibration or to add additional axes to a system.

Mounting of the transducer head is with a bracket that can be modified to fit an existing scanner. It accepts a variety of PA transducers. Two perpendicular rotational axes are set to the required directions. Adjustment set screws are integrated to minimize backlash and to properly position the worm gear mechanisms. A conventional UT adaptor is offered in option.

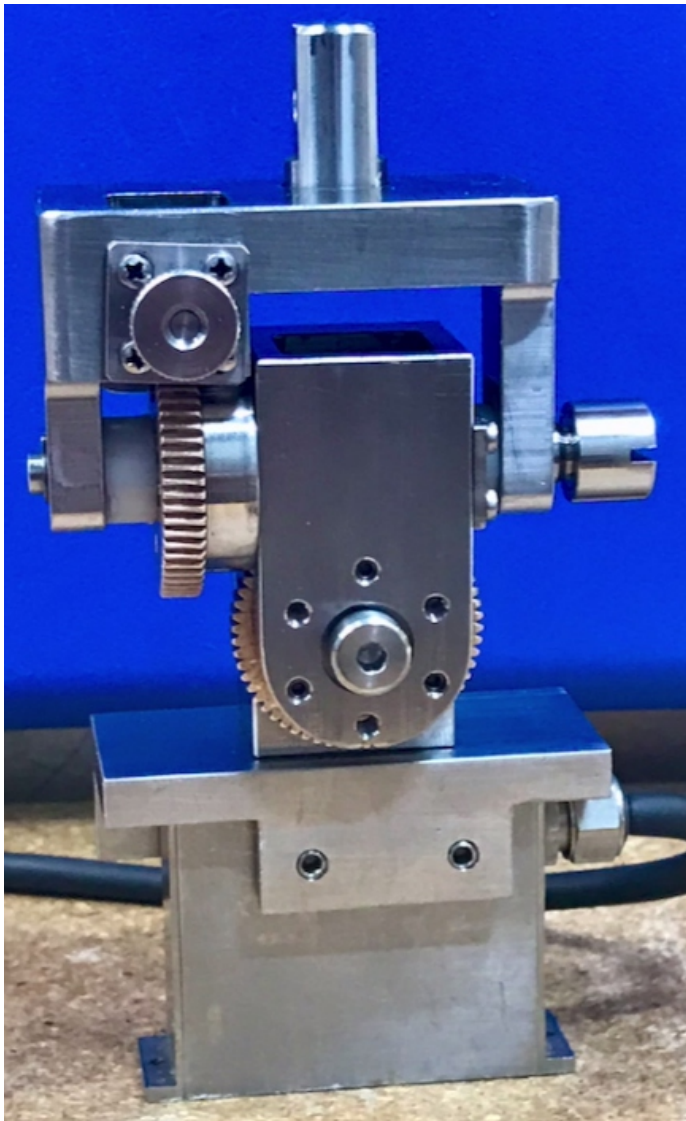

DESIGN

- Rugged Stainless Steel material
- Two bronze gear assembly
- Gimbal: - Main Angulation -95 to 45 degrees
 - Secondary angulation (perpendicular to the main angulation): -45 to + 45 degrees
- Approximate dimension: 75 x 50x 90 mm
- Approximate weight: 1 Kg

Designed for PA
Two control axes
Adaptor for conventional
UT

GIMBAL
MANIPULATOR

GIMBAL MANIPULATOR

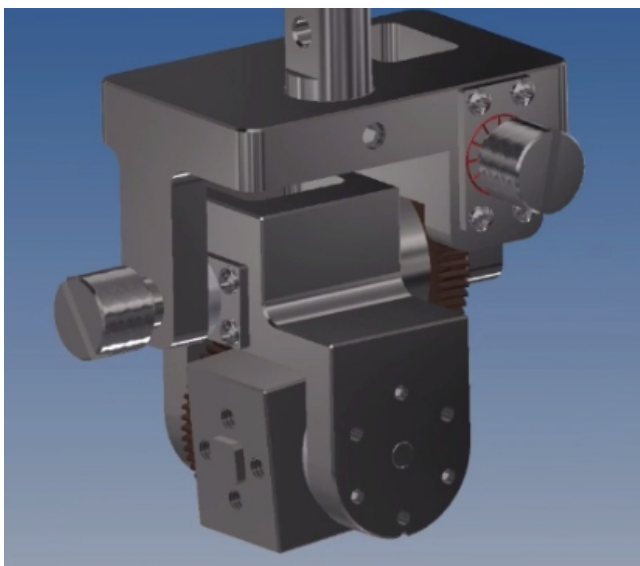
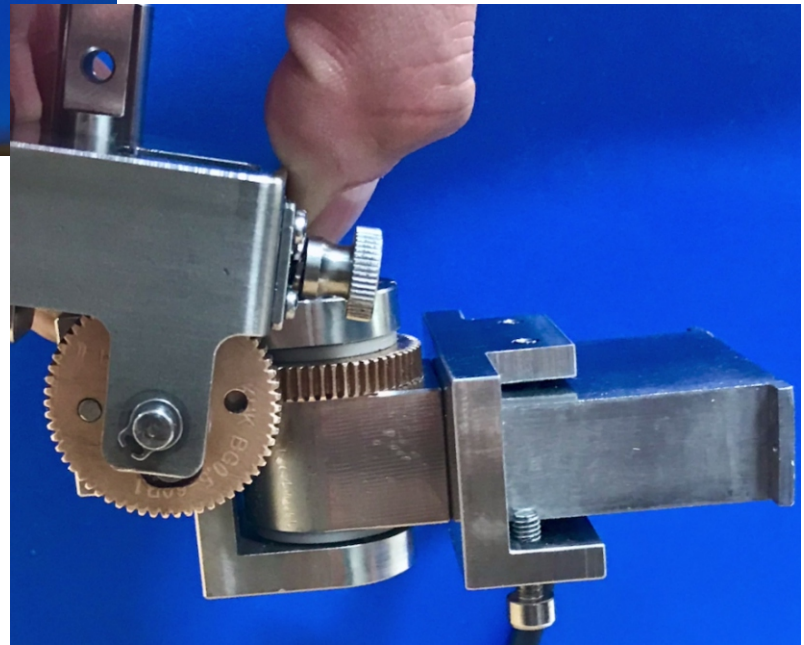
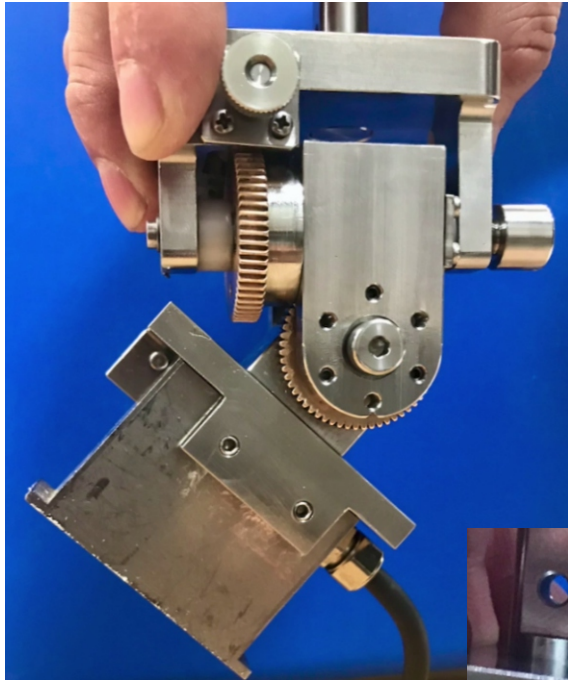

GIMBAL MANIPULATOR

For Phased Array or
Conventional UT

Part Nbr: GGPA



2029 Michelin
Laval, Quebec
Canada
450.688.1118
www.tdnde.com
info@tdnde.com